

The Japser Park Mews

Set on the edge of parkland and within easy access to lots of shops and facilities, Park Mews is a fantastic new community development that's just waiting for you to move in.

Ground Floor

Kitchen & Dining Area
4.31 x 2.50m
14'2" x 8'2"

Lounge
4.73 x 3.30m (max)
15'6" x 10'9" (max)

Hall

WC

First Floor

Bedroom 1
2.83 x 2.26m
9'3" x 7'5"
En Suite

Bedroom 2
2.75 x 2.35m
9' x 7'9"

Bedroom 3
3.12 x 1.96m
10'3" x 6'5"

Bathroom

Landing

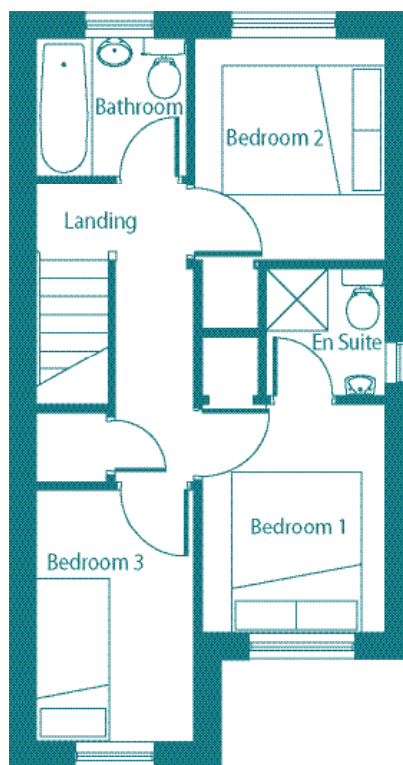
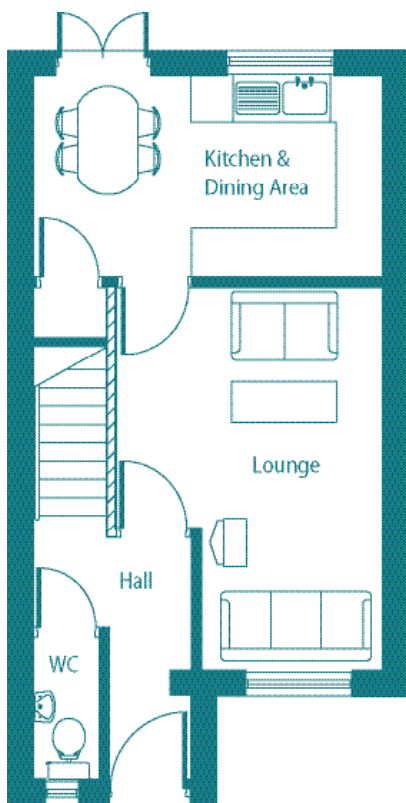

Start planning your new home... now!

For more information call Connells on 0121 525 1177,
visit www.connells.co.uk or email westbromwich@connells.co.uk